

# CONTRY HOMES

## THE 1524 TWO STORY

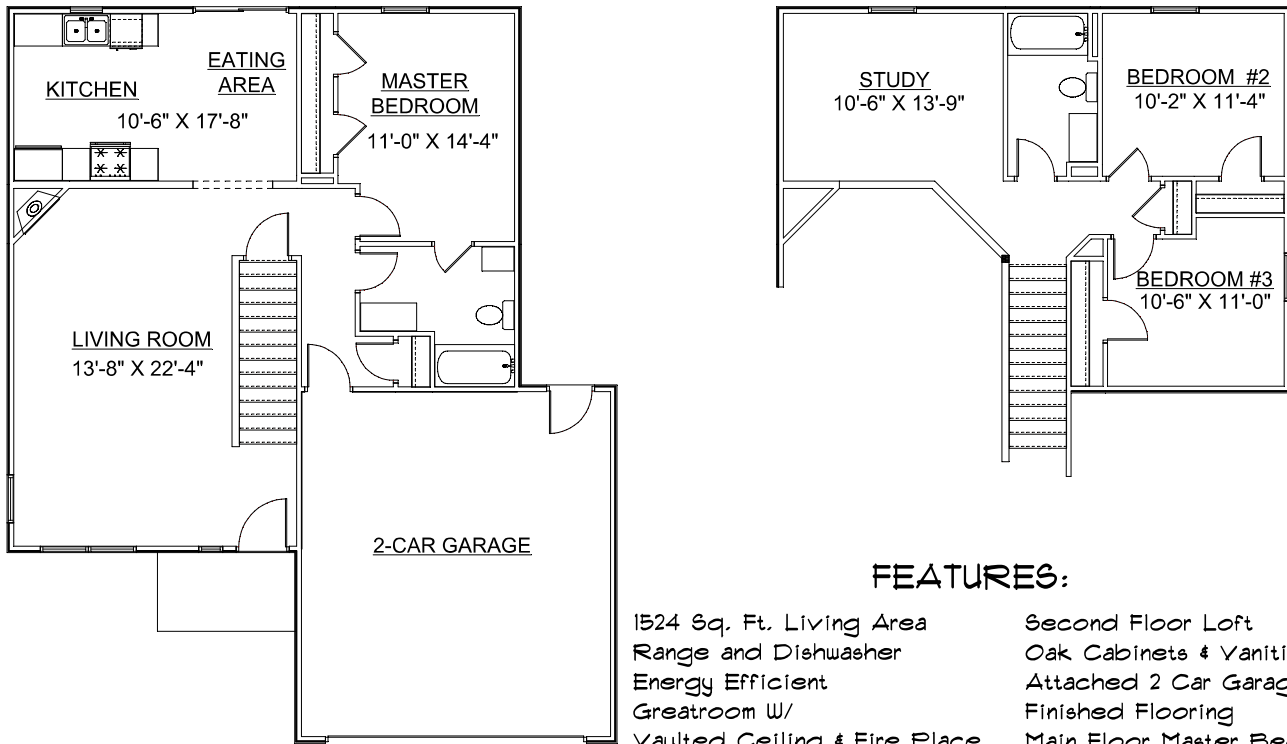

### FEATURES:

- 1524 Sq. Ft. Living Area
- Range and Dishwasher
- Energy Efficient
- Greatroom W/ Vaulted Ceiling & Fire Place
- 3 Bedroom
- 2 Baths
- Second Floor Loft
- Oak Cabinets & Vanities
- Attached 2 Car Garage \*
- Finished Flooring
- Main Floor Master Bedroom
- \* Optional 3rd Car Garage

**JOE CONTARINO**  
 Broker Associate  
 Dickerson & Nieman-Realtors  
 Office (815) 399-8100  
 Email: [info@contryhomes.com](mailto:info@contryhomes.com)  
 Web: [www.contryhomes.com](http://www.contryhomes.com)

\* All Dimensions are Approximate \*

\* Note: All elevations are representative only and subject to change without notice. Consult a Contry Homes representative for details.